

Boise Depot Reservations

2603 W. Eastover Terrace

Alcohol is NOT PERMITTED outside of areas rented. This includes the street and/or in the Platt Gardens/Park.

To assist you in planning and layout of your event, we have provided tables for you to cut, move and paste for the caterer and reservationist.

Key to the rentable and non-rentable areas of the Boise Depot and capacities.

- Great Hall**
 300 standing/165 seated
- North Plaza**
 100 standing or seated
- South Plaza**
 50 standing or seated
- Fire Lanes**
- Non-rentable**
- Tower**

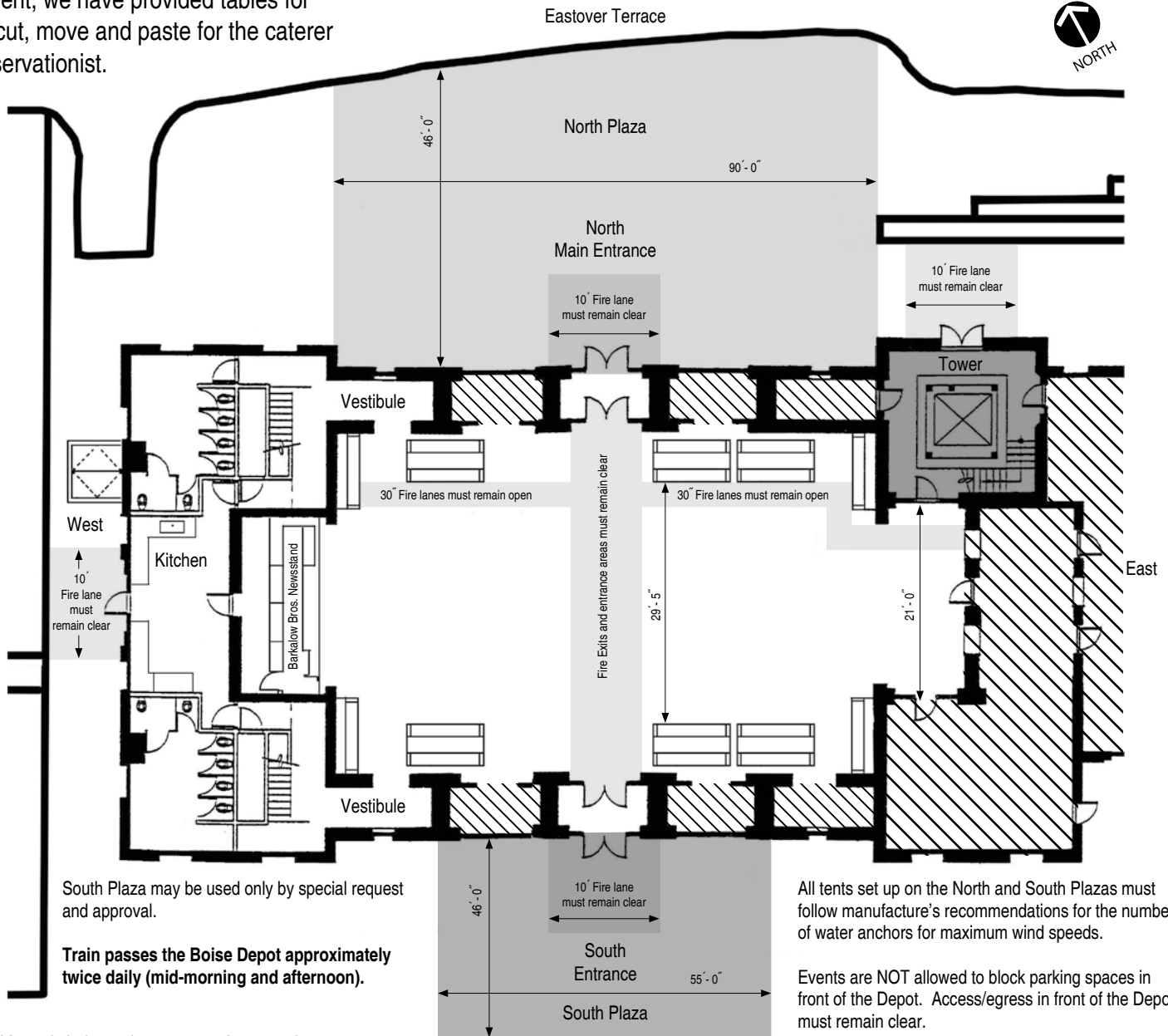

Cut out table and chairs and arrange on the map above. Scale is approximate.

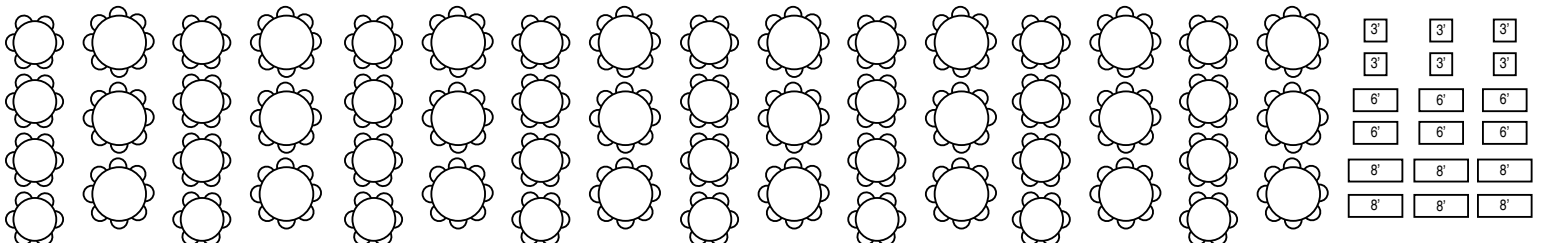

Boise Depot Reservations

2603 W. Eastover Terrace

The Boise Depot is a beautiful historic Mission-style building with a panoramic view of Downtown Boise. Operated by the City of Boise as a public meeting space, the surrounding grounds and Great Hall offer a one-of-kind opportunity for weddings, receptions, fund-raising events, corporate parties, breakfasts, lunches or dinners.

The Boise Depot is located at the south end of Capitol Blvd. at 2603 W. Eastover Terrace Boise, Idaho 83706

Parking*:
 Eastover Terrace..... 73 spaces
 Gravel Area off Ruby St. 34 spaces

Parking is limited to designated areas and open to the public, on a first come, first serve basis. Blocking parking spaces, closing the road, etc., is prohibited without a permit from Ada County Highway District, 378-6178.

For general information or to schedule a reservation, contact:
reserve@cityofboise.org
 or
cityofboise.org/parks/reservations
 or call/fax:
 208-608-7644
 Fax 208-608-7648
 TDD/TTY 800-377-3529

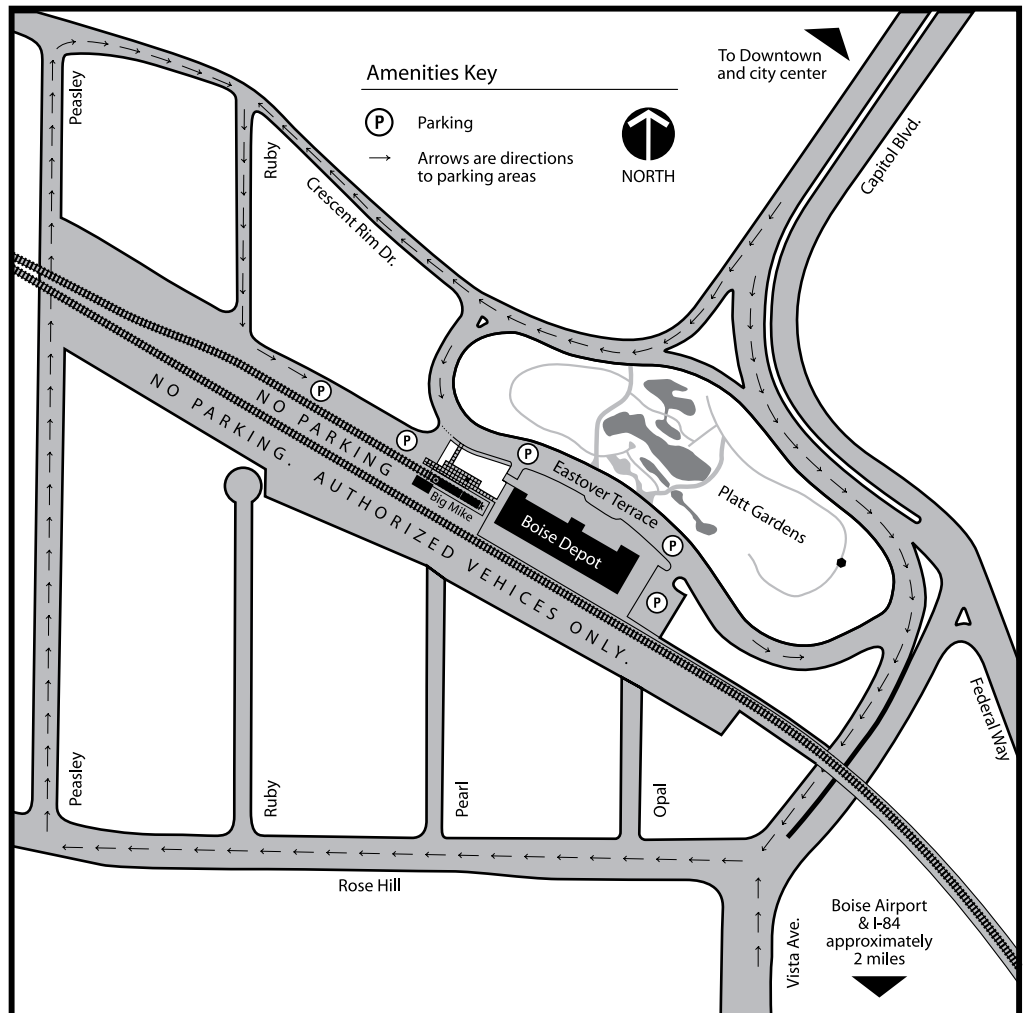

Access to the Boise Depot from Crescent Rim Dr. and Eastover Terrace. Overflow parking is on the north side of the the railroad tracks off Ruby St.

NOTES:
