

Welcome



We invite you to:

- Review plans to improve the sustainability and capacity of the Lander Street Water Renewal Facility.
- Speak one-on-one with project staff and provide comments.
- Learn what's next and how to stay involved.

Background



- The Lander Street Water Renewal Facility was built in 1948 and is one of two water renewal facilities in the City of Boise.
- In 2015, the city studied the option of closing the Lander Street facility. The study concluded **the benefits of keeping the facility open far outweighed the costs** of major updates.
- Over the next several years, new sustainable water renewal practices will be added and aging equipment and disinfection processes will be replaced. These updates will require expanding the footprint of the facility.



Community Engagement

- **Workshop #1 (June, 2017):** Facility improvements and potential changes to the area.
- **Workshop #2 (August, 2017):** Range of potential improvements, including Greenbelt access, fencing and parking.
- **Open House (December, 2017):** Additional input and questions about the project.
- **Workshop #3 (May, 2018):** Input about current plans.

The city will continue to work with the community as this project continues.

We Heard You

Several community requests were incorporated into the design of this project:

- Preserving the existing pond area, supporting area wildlife
- Relocating the public restroom
- Replacing any trees that must be removed
- Pursuing an access from Veterans Memorial Parkway



Master Plan

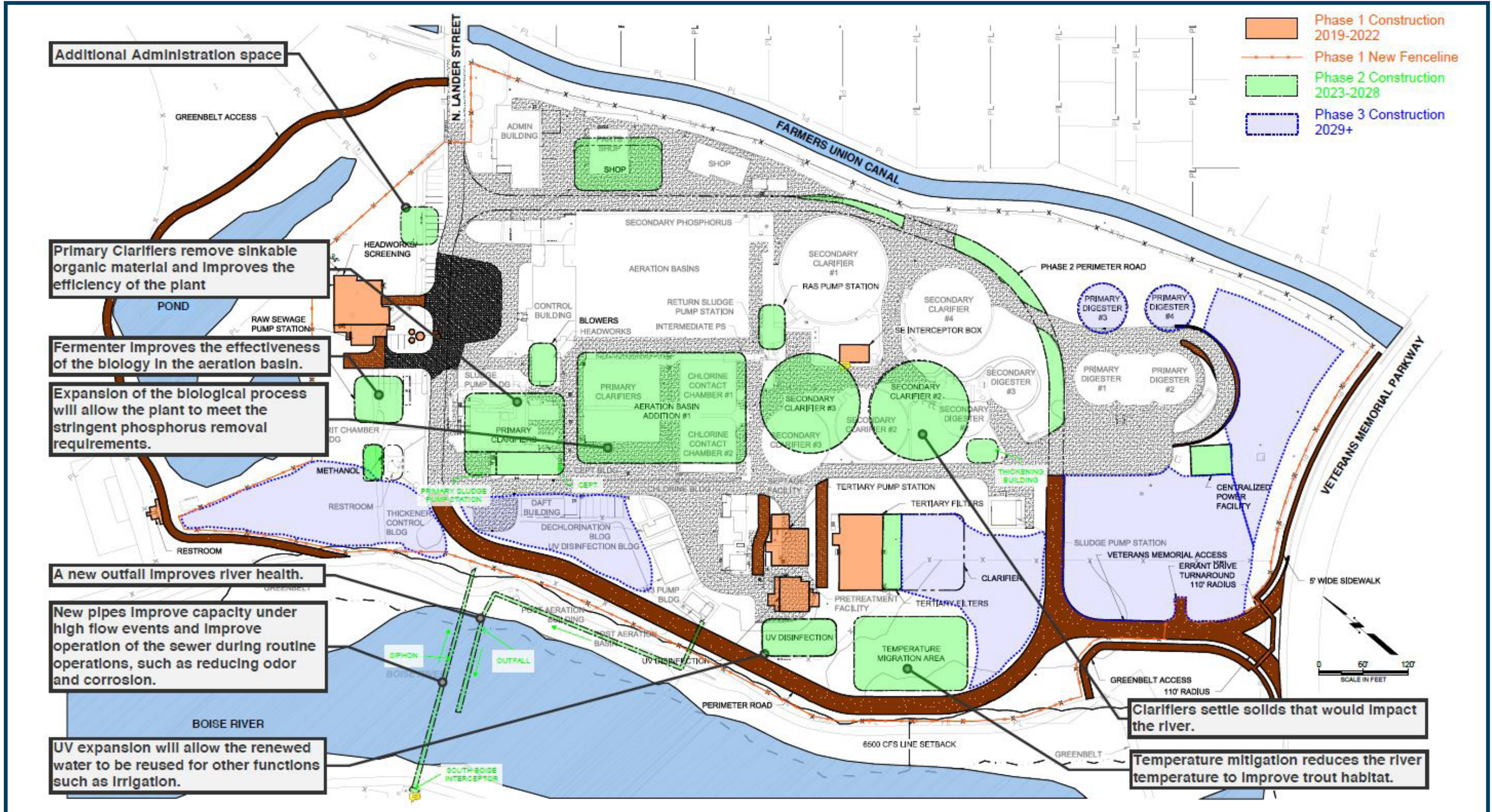

Aerial View



Aerial image: © 2018 Google Earth Landsat/Copernicus. Annotation: © 2018 Jacobs.

Viewpoints Master



Viewpoint

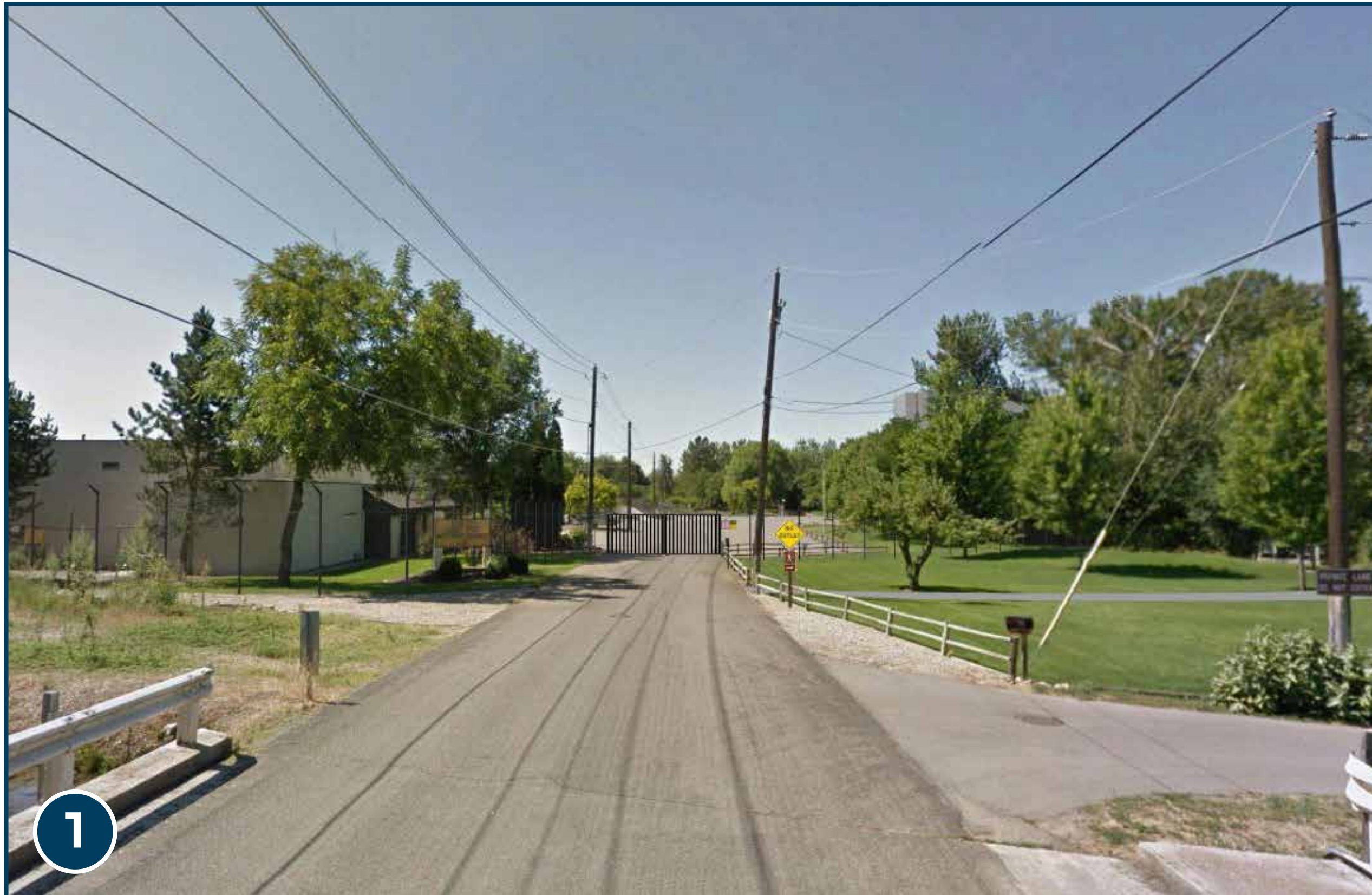

Aerial image: © 2018 Google Earth Landsat/Copernicus. Annotation: © 2018 Jacobs.



Viewpoint



Aerial image: © 2018 Google Earth Landsat/Copernicus. Annotation: © 2018 Jacobs.

Viewpoint



Aerial image: © 2018 Google Earth Landsat/Copernicus. Annotation: © 2018 Jacobs.

Viewpoint

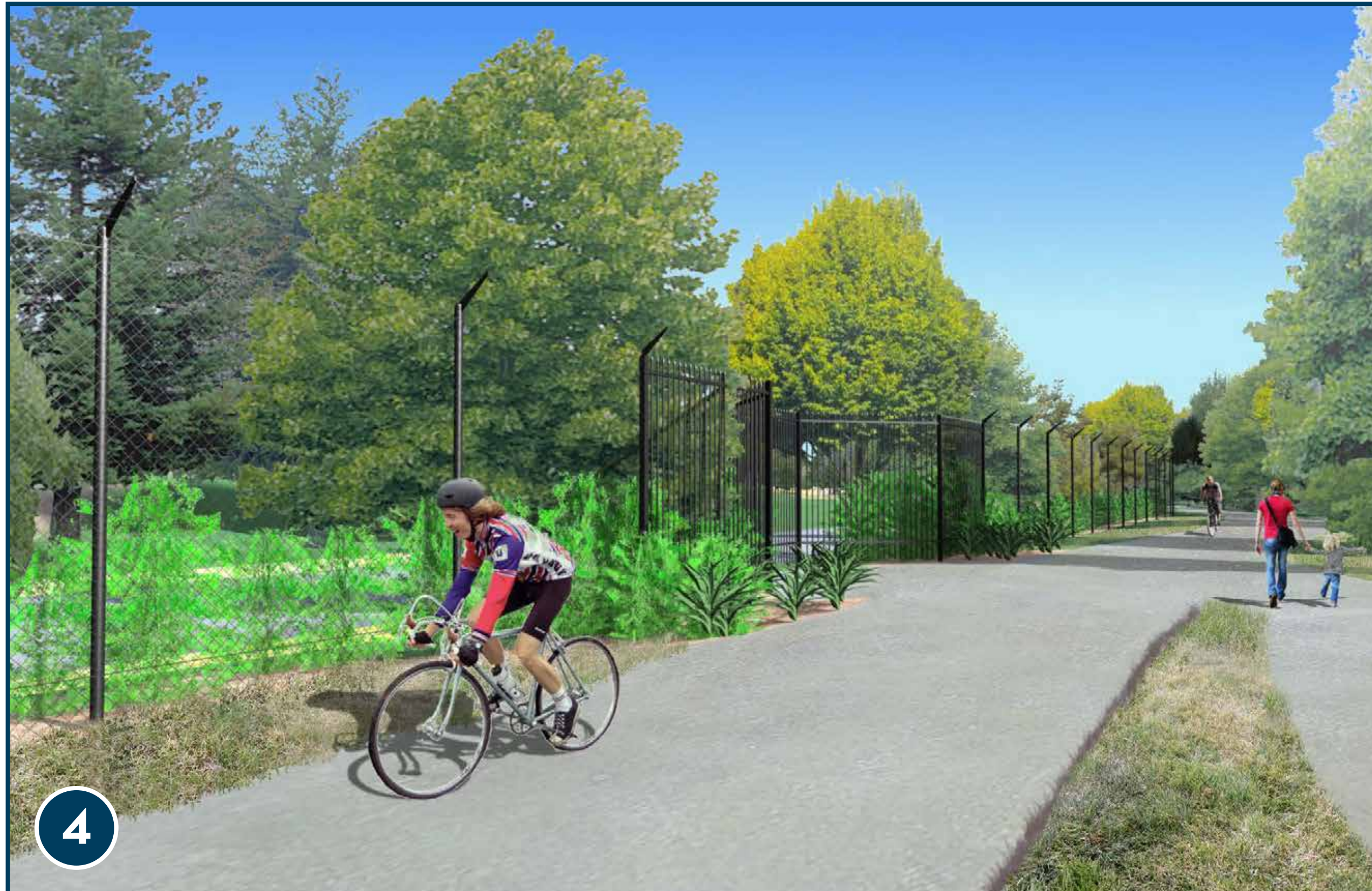

Aerial image: © 2018 Google Earth Landsat/Copernicus. Annotation: © 2018 Jacobs.

Viewpoint



5

Viewpoint



6

Landscaping Site Plan



Landscaping Section and Materials

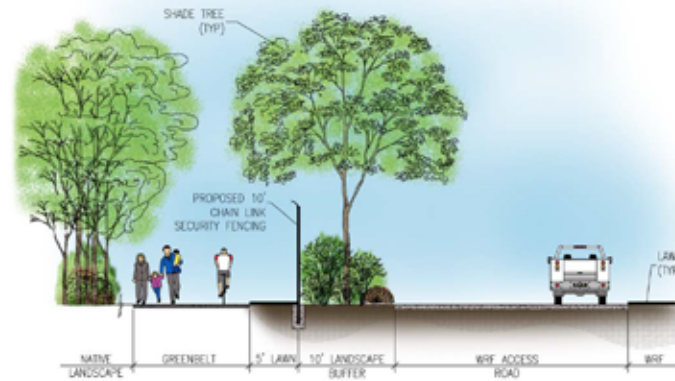

GREENBELT SECTION A-A

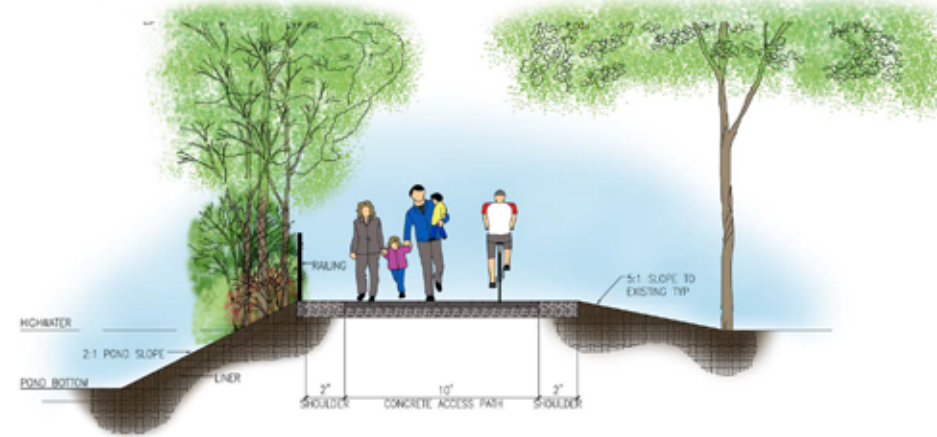

ACCESS PATH SECTION D-D

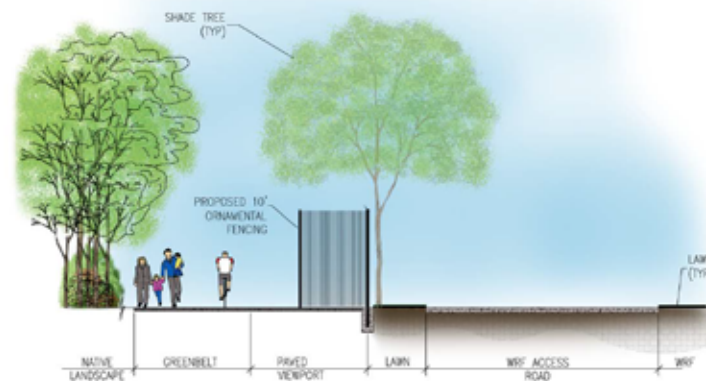

GREENBELT SECTION B-B

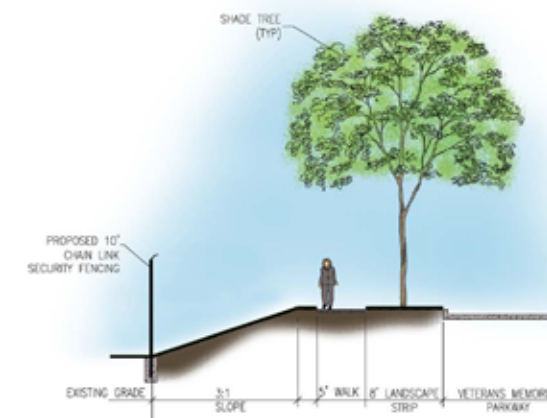

VMP LANDSCAPE STRIP SECTION E-E



10' TALL ORNAMENTAL FENCE

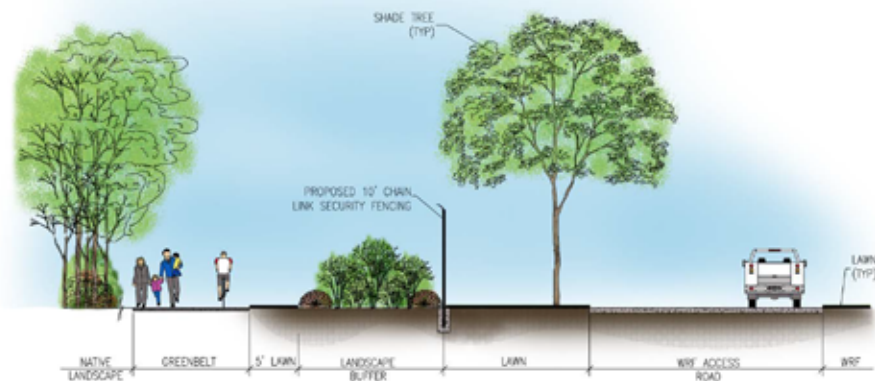

GREENBELT SECTION C-C



10' TALL CHAIN LINK FENCE



Why Build an Access from Veterans Memorial Parkway?

- Improve safety for construction and maintenance traffic, which are currently required to cross multiple lanes on State Street.
- Reduce the potential for conflicts with pedestrians and parked cars along Lander Street.
- Improve response times to the facility during flood events or other emergencies.
- Reduce deterioration of the pavement and bridge on Lander Street.
- Decrease neighborhood noise and dust from heavy construction loads.
- Allow uninterrupted use of the facility when one access point is blocked.

Access Option 1: (preferred) Veterans Memorial Parkway

- Right-in, right-out road for construction and facility maintenance vehicles only. The entrance will be gated for access control and safety.
- During construction, approximately 100 passenger vehicle trips and 5 to 17 heavy truck trips would be diverted each day from using Lander Street.
- The city is applying for a variance from the Ada County Highway District (ACHD) to build the access.
- The ACHD Commission will make a decision about the city’s application at a public hearing. Members of the public are invited to give comments. The project website will keep you informed about the date.



Access Option 2 (existing): Lander Street

Construction and facility vehicles will continue to use Lander Street.

- Approximately 60 passenger vehicles and 2 to 4 trucks currently enter and exit the Lander facility each day.
- 5 to 17 additional trucks will be necessary each day during construction. Up to 100 construction passenger vehicles will enter and exit the site each day during construction.
- Construction trucks will vary in size from dump trucks to tractor trailers.
- Expanding the facility is expected to require an additional 20 passenger vehicles. Maintenance truck traffic is expected to double for day-to-day operations.

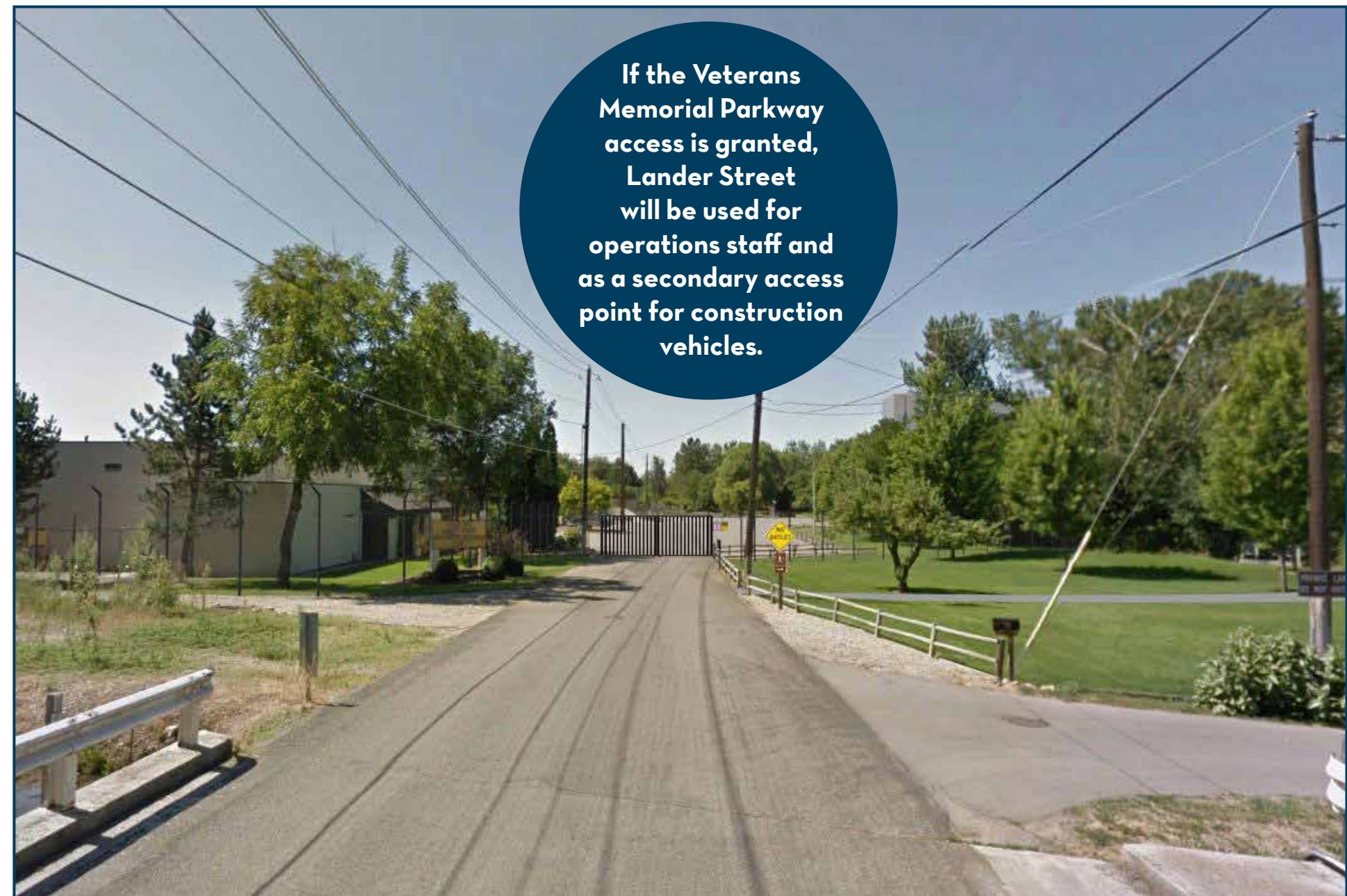

Aerial image: © 2018 Google Earth. Annotation: © 2018 Jacobs.

Project Schedule



Early 2018	Present plans at community open house Develop construction plans and schedule Continue engineering work for facility upgrades
Summer 2018	Request Conditional Use Permit* at a public hearing (*A land use permit from the Planning and Zoning Commission)
Fall 2018/ Winter 2019	Begin construction; ongoing communication with community
Summer 2023	Depending on funding, Phase I is expected to be complete.

Construction

Construction of the facility improvements will occur in three phases. The first phase could begin as early as 2018 and take four years to complete.

- Construction will occur during daytime hours (7 a.m. – 4 p.m.) with some exceptions.
 - During major concrete placements, work will start very early in the morning to reduce the impact of traffic.
- Fencing will be constructed around the new footprint of the facility.
- The Greenbelt will be open during construction.
- Greenbelt access from Lander Street will be temporarily re-routed through Willow Lane Park. Intermittent closures may be necessary on this temporary route.
- Road closures are not anticipated during construction.
- Maintained access to bus stops, or coordination of new locations, if necessary.
- Very limited nighttime noise during construction.



What's Next

- Review comments from today's meeting and update the plans as needed.
- City of Boise's Planning & Zoning Commission will hold a public hearing to consider whether to approve changes to the area. If the project is approved, the Commission will issue a Conditional Use Permit.
- The city will host a community open house prior to construction.
- Phase I of construction could begin as early as 2018. Phase I includes Greenbelt access, new fencing, landscaping, headworks, filters and UV disinfection.
- If you have questions or would like more information, please contact us at **LanderStreetProject@cityofboise.org** or visit **publicworks.cityofboise.org/LanderStreet**.

Thank you for attending today's open house!